

Male Stud Barrel Tee Couplings

LE-G

Dimensions in mm

DIN Fittings

Metric Tube end as per ISO 8434
and BSPP (G) stud end

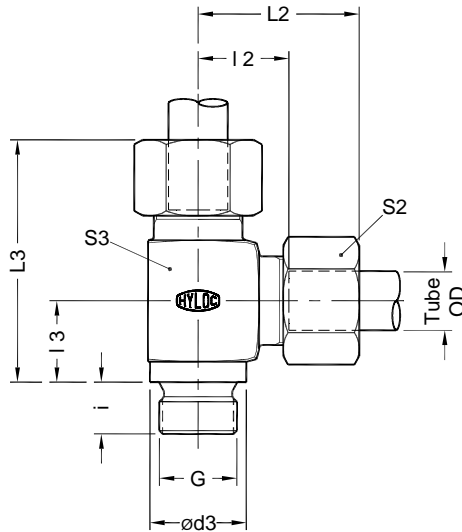

Part No.	Series	Tube od	G Male BSP thread	ø d3	i	I 2	I 3	* L2	* L3	S2	S3
LE22PLG	160 bar	22	G 3/4 A	32	16	27.5	26	44.5	70.5	36	32
LE28PLG	100 bar	28	G 1 A	39	18	30.5	30	48.5	78.5	41	41
LE35PLG	Light L	35	G1 1/4 A	49	20	34.5	34	57.5	91.5	50	50
LE42PLG		42	G1 1/2 A	55	22	40.0	39	63.5	102.5	60	55
LE20PSG	400 bar	20	G 3/4 A	32	16	26.5	26	49.0	75.0	36	32
LE25PSG	Heavy S	25	G 1 A	39	18	30.0	30	55.0	85.0	46	41
LE30PSG	250 bar	30	G1 1/4 A	49	20	35.5	34	63.5	97.5	50	50
LE38PSG		38	G1 1/2 A	55	22	41.0	39	72.5	111.5	60	55

* Dimensions given are approx figures with tightened nut.