

# Swivel Barrel Tee Couplings

**EVL**

Dimensions in mm

DIN Fittings

Metric Tube end as per ISO 8434

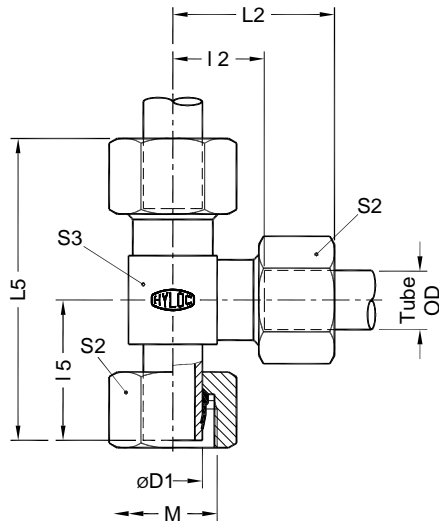

Part No.	Series	Tube od (øD1)	M	I 2	I 5	* L2	* L5	S2	S3
<b>EVL06PL</b>	<b>Light L</b> 250 bar	6	M12 x 1.5	12.0	26.0	27.5	53.5	14	12
<b>EVL08PL</b>		8	M14 x 1.5	14.0	27.5	29.0	56.5	17	14
<b>EVL10PL</b>		10	M16 x 1.5	15.0	29.0	30.5	59.5	19	17
<b>EVL12PL</b>		12	M18 x 1.5	17.0	29.5	32.0	61.5	22	19
<b>EVL15PL</b>		15	M22 x 1.5	21.0	32.5	37.0	69.5	27	22
<b>EVL18PL</b>	160 bar	18	M26 x 1.5	23.5	35.5	40.5	76.0	32	27
<b>EVL22PL</b>		22	M30 x 2.0	27.5	38.5	44.5	83.0	36	30
<b>EVL28PL</b>	100 bar	28	M36 x 2.0	30.5	41.5	48.5	90.0	41	36
<b>EVL35PL</b>		35	M45 x 2.0	34.5	51.0	57.5	108.5	50	46
<b>EVL42PL</b>		42	M52 x 2.0	40.0	56.0	63.5	119.5	60	55
<b>EVL06PS</b>	<b>Heavy S</b> 630 bar	6	M14 x 1.5	16.0	27.0	31.5	58.5	17	14
<b>EVL08PS</b>		8	M16 x 1.5	17.0	27.5	32.0	59.5	19	17
<b>EVL10PS</b>		10	M18 x 1.5	17.5	30.0	34.5	64.5	22	19
<b>EVL12PS</b>		12	M20 x 1.5	21.5	31.0	38.0	69.0	24	22
<b>EVL16PS</b>	400 bar	16	M24 x 1.5	24.5	36.5	43.5	80.0	30	24
<b>EVL20PS</b>		20	M30 x 2.0	26.5	44.5	49.0	93.5	36	30
<b>EVL25PS</b>		25	M36 x 2.0	30.0	50.0	55.0	105.0	46	36
<b>EVL30PS</b>	250 bar	30	M42 x 2.0	35.5	55.0	63.5	118.5	50	46
<b>EVL38PS</b>		38	M52 x 2.0	41.0	63.0	72.5	135.5	60	55

\* Dimensions given are approx figures with tightened nut.