

## Monoblock Type Directional Control Valves

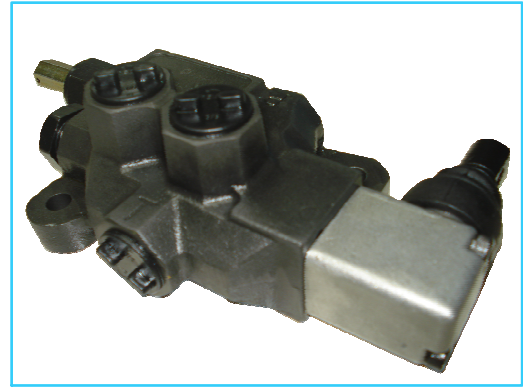

## Specification

Model Number	Max. Flow Rate L/Min.	Max. Oper. Pressure Kgf/cm <sup>2</sup>	Max. Back Pressure Kgf/cm <sup>2</sup>	Relief Valve	Spool Leakage (at 100 Bar, 50 <sup>o</sup> C & 32 cSt)		Oil Temp. (Max)	Material Specification		Std. Feature	Optional Feature
					Min.	Max.		Body	Spool		
MDM03-01-※-※-21	40	320	30	Adjustable direct acting Relief valve	5 cm <sup>3</sup> /min.	12 cm <sup>3</sup> /min. (Lower values on demand available)	80 <sup>o</sup> C	High Wear resistance Cast iron	Hardened Steel	a. Handle with Rubber Grip & Bellows b. 3 Spool Position	Spool without handle & with rod – eye only also available on demand

## Model Number Designation

MDM	03	-01	-B	-2	D	-21
Series Number	Valve Size	No. of Spools	Relief Spring Type/Range	Spool Type	Detent	Design No.
MDM (Monoblock Type)	03	01	A- 30~95 Kgf/cm <sup>2</sup> B- 96~210 Kgf/cm <sup>2</sup> C- 211~320 Kgf/cm <sup>2</sup> N- No Relief valve required	As above 2, 4, 8A, 8B, 5	If required Specify D or else omit	21*

- \* For valve control with lever unit and handle the design no. is 21
- \* For valve control without lever unit and without handle the design no. is 21N
- \* For valve control with lever unit and without handle the design no. is 21S

## List of Spools

Type	Spool Scheme	Spool Features
2		4-Way-3 Position A/B blocked, E- open to Tank in neutral position.
4		4- way -3 position A/B to tank, E-open to Tank in neutral position.
8A		3-way-3 position A blocked, E-open to Tank in neutral position.
8B		3-way-3 position B blocked, E-open to Tank in neutral position.
5		4-way-3 position E blocked in neutral P open to B in neutral position.

● MDM03-01-※-※-21

